

## TECHNICAL DATA

Cage Size (L X W X H)	3,0 m X 1,5 m X 2,1 m (Internal dimensions)		Max Payload	1500 Kg or 17 people 2000 Kg available on request	
Speed	E15/30	24 m/min	Motors Power	E15/20	2 X 5,5 Kw
	E15/40	0-40 m/min (with VFC)		E15/40	2 X 13 Kw (with VFC)
VFC Power	E15/30	22 Kw	Brake resistor	E15/30	2 X 9,5 Kw (with VFC) - 20Kw
	E15/40	30 Kw		E15/40	24 Kw
Power Supply	400 V 50 Hz - Three phase (*)		Tools socket power supply	220 V single phase (*)	
Motor brake power supply	230 V		Secondary circuit voltage	24 V	
Absorption Max Load	E15/20	23,2 A	Absorption at start-up	E15/30	160 A
	E15/40	53 A		E15/40	99 A
Control System for landings	- Stop next landing or - Automatic (with encoder)		Cabin doors type	Vertical Sliding	
Mast element weight Single cage	70 Kg		Mast element height	1,5 m	
Rack Module	M6		Mast type	Square trellis mast	
Max Wall Ties Distance	6 m		Cable Guides Distance	10 m	
Max working height	200 m		First tie at	6 m if base foundation	
Top overhang in operation	4,5 m		Top overhang on erection	6 m	

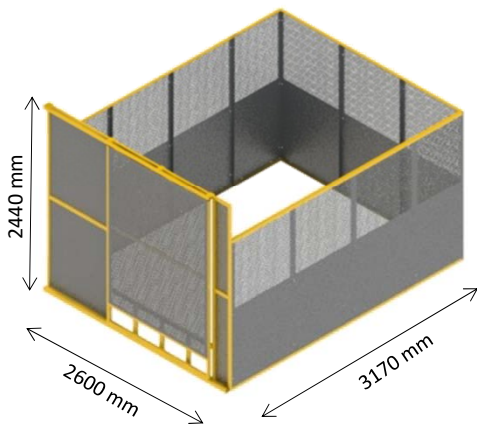

**Ground Dimensions**

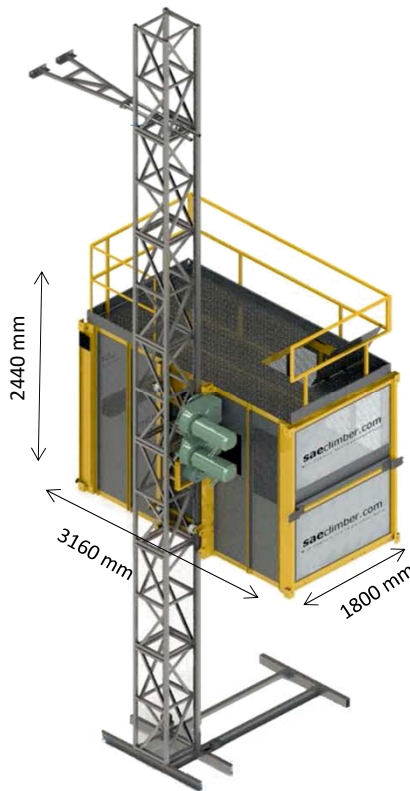

**Cabin Ext. Dimensions**

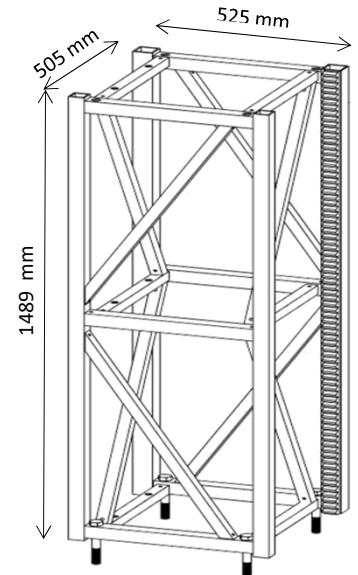

**Mast Dimensions**

NOTES:(\*) Other values on request - (\*\*): Optional - The Manufacturer reserves the right to change any of the above data without notice

## SAFETY FEATURES

- First class geared motors self braking type (SEW Germany)	- First class Variable Frequency Converter (Schneider or equivalent)
- Overload device made with Load cells	- External independent parachute emergency brake (CE certified)
- Digital programming floor stop (Automatic control) with encoder	- Device for manual descent in case of power failure
- Digital Diagnostic of malfunctioning (Visualization on cage display)	- Internal light with battery in emergency
- Roof Trap door provided with safety switches	- Rubber shock absorber at the base
- Roof fences for protection during assembly operation	- Rack interrupted on the terminal mast element to avoid overrun
- Low voltage Electrical panel	- 220 V socket on board for tools
- Detection of correct phase	- Changing phase device
- Cabin doors with safety electro-mechanical interlock	- Landing doors, with safety electro-mechanical interlock and call
- Limit switch checking mast element presence	- Limit switch for doors and ramps
- Emergency push button	- Ascent, Descent, overrun and Emergency limit switches
- Jib for erection with electric winch	- Cable Guides and cable basket - Cable Trolley on request
- Erection ramp with safety handrail	- Erection remote control / Drop test remote control
- Low Temperature Kit , Hours counter and Automatic greasing pump available on request (**)	

Notes: Hot dip galvanised cage, ground enclosure, gates, doors, handrails, mast sections, wall Ties, ladders, chassis

**Standard tie type**

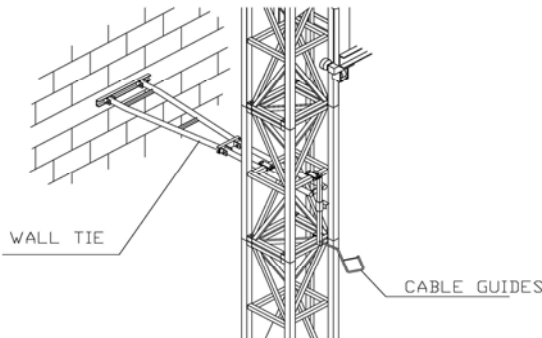

**Cable Trolley**

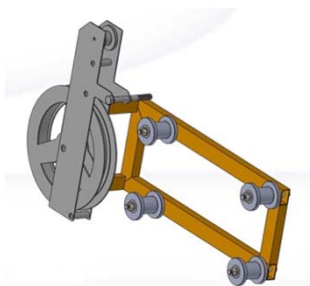

**Standard Landing door Interlocked (no opening if the cage is not at the floor)**

